

SAINT-PRIX

 ESPACE NATUREL SENSIBLE

 DES COTEAUX DE SAINT-PRIX

 ZONE C

 Echelle : 1/1.500

PLAN PARCELLAIRE

Direction et dessin par
 M. Didier DISSANNE
 57 Avenue de la République
 95200 Saint-Prix
 Tél. 01 39 06 04 20
 Fax. 01 39 96 34 33



Observations :

Date : JUILLET 2003
 Clauses : 2004
 Contenu : 2004

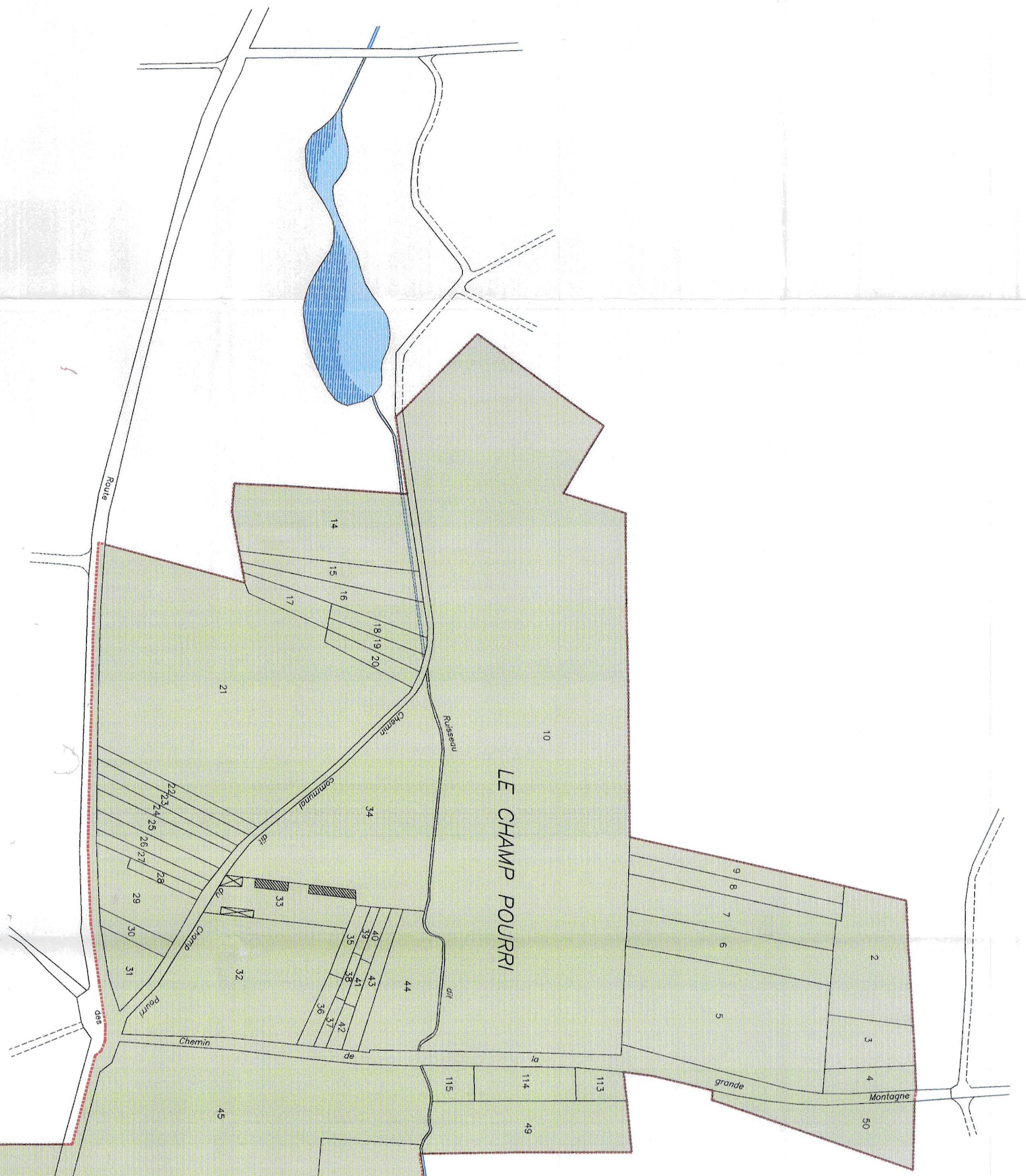

 CONSEIL GÉNÉRAL
 DU VAL DE SEINE

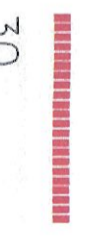

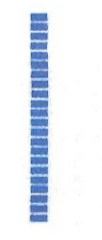
-  ESPACE NATUREL SENSIBLE
-  LIMITE DE LA ZONE
-  EMPRISE PARCELLAIRE TOTALE
-  EMPRISE PARCELLAIRE PARTIELLE
-  LIMITE DE SECTION

